

**HASKELL COUNTY, TEXAS PUBLIC NOTICE OF A MEETING AT WHICH  
THE HASKELL COMMISSIONERS COURT WILL CONSIDER THE APPROVAL OF  
A FIRST AMENDMENT TO TAX ABATEMENT AGREEMENT  
WITH KING CREEK WIND FARM 1, LLC**

Pursuant to the Section 312.207 of the Texas Tax Code, notice is hereby given that the Haskell County Commissioners Court will consider the approval of a First Amendment to Tax Abatement Agreement between Haskell County, Texas and King Creek Wind Farm 1 LLC at a regularly scheduled meeting of the Commissioners Court.

**Time and Place of the Meeting.** The First Amendment to Tax Abatement Agreement will be considered during the regularly scheduled meeting of the Haskell County Commissioners Court on Tuesday, July 12, 2022 at 10:00 a.m. in the Haskell County Commissioners Courtroom located at 1 Avenue D, Haskell, Texas 79521.

**Tax Abatement Agreement Information Required by Texas Tax Code Section 312.207.** Pursuant to Section 312.207 of the Texas Tax Code, the following information is provided regarding the proposed First Amendment to Tax Abatement Agreement with King Creek Wind Farm 1 LLC:

1. **Name of property owner and applicant for tax abatement agreement:**  
King Creek Wind Farm 1 LLC
2. **Name and location of reinvestment zone in which the property subject to the agreement is located:**  
Haskell County Reinvestment Zone 01-2020 as shown by the Map and Legal Description in Exhibit A, attached hereto.
3. **General description of the nature of the improvements included in the agreement:**  
38 MW wind powered electric generation facility located in Haskell County, Texas consisting of wind turbines and towers, transmission lines, electrical connections, roads, control systems necessary for commercial generation of electricity, turbines, towers, foundations, roadways, meteorological towers, collection system, communication system, electric switchyard, electric transformers, transmission line and associated towers, interconnection facilities would be located in the Haskell County Tax Abatement Reinvestment Zone, Haskell County RZ 01-2020.
4. **Estimated cost of the improvements:**  
Eighty Six million four hundred thousand dollars (\$86,400,000.00).
5. **General description of requested amendment to Tax Abatement Agreement:**  
Requested approval of Delay Notice of the substantial completion of the improvements completed by March 31, 2022.

The First Amendment to Tax Abatement Agreement described in this notice also will appear on the agenda that is posted in accordance with the Texas Open Meetings Act for the scheduled Tuesday, July 12, 2022, meeting of the Haskell County Commissioners Court. This notice is given in the manner required by the Texas Open Meetings Act at least 30 days before the scheduled time of the meeting described in this notice.

*[The remainder of this page intentionally left blank.]*

**EXHIBIT "A"**  
**Depiction of Property Subject to First Amendment to**  
**Tax Abatement Agreement**  
**Map**

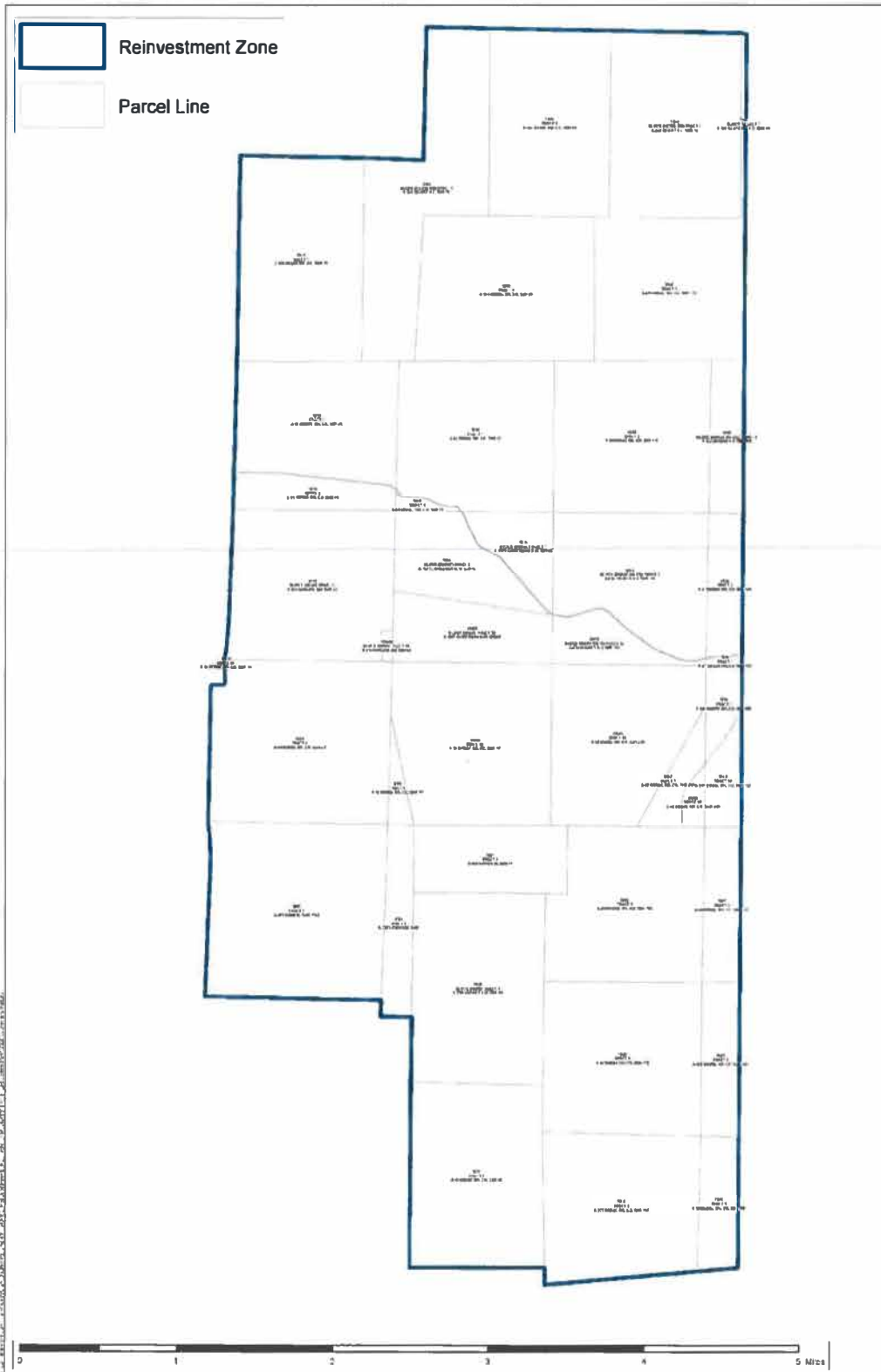

**EXHIBIT A**  
page 2

**Legal description of real property in the  
Reinvestment Zone.**

<b>EXHIBIT -A-</b>				
<b>County</b>	<b>Parcel ID</b>	<b>Legal Acreage</b>	<b>Legal Description 1</b>	<b>Legal Description 2</b>
Haskell	2384	150.0 ACRES	A-737 LAWRENCE S.W.	TRACT 1
Haskell	3865	876.8 ACRES	A-121 DUNN W. SUR #160	TRACT 1
Haskell	5819	643.5 ACRES	A-53 BBB&C RR. CO. SUR #3	TRACT 1
Haskell	5819	643.5 ACRES	A-53 BBB&C RR. CO. SUR #3	TRACT 1
Haskell	5820	60.8 ACRES	A-54 BBB&C RR. CO. SUR #7	TRACT 1
Haskell	5821	647.1 ACRES	A-55 BBB&C RR. CO. SUR #9	TRACT 1
Haskell	5822	641.0 ACRES	A-57 BBB&C RR. CO. SUR #13	TRACT 1
Haskell	5823	646.8 ACRES	A-58 BBB&C RR. CO. SUR #17	TRACT 1
Haskell	5824	148.4 ACRES	A-59 BBB&C RR. CO. SUR #25	TRACT 1
Haskell	5825	173.8 ACRES	A-60 BBB&C RR. CO. SUR #23	TRACT 1
Haskell	5826	167.5 ACRES	A-61 BBB&C RR. CO. SUR #21	TRACT 1
Haskell	5826	167.5 ACRES	A-61 BBB&C RR. CO. SUR #21	TRACT 1
Haskell	5827	74.5 ACRES	A-62 BBB&C RR. CO. SUR #15	TRACT 1
Haskell	5828	649.0 ACRES	A-63 BBB&C RR. CO. SUR #5	TRACT 1
Haskell	5828	649.0 ACRES	A-63 BBB&C RR. CO. SUR #5	TRACT 1
Haskell	5829	641.64 ACRES	A-64 BBB&C RR. CO. SUR #1	TRACT 1
Haskell	5830	641.6 ACRES	A-467 GC&SF RR. CO. SUR #3	TRACT 1
Haskell	5831	646.0 ACRES	A-468 GC&SF RR. CO. SUR #1	TRACT 1
Haskell	5832	634.0 ACRES	A-513 NABORS J.W. SUR #8	BLOCK BBB&C TRACT 1
Haskell	5833	641.3 ACRES	A-514 NABORS J.W. SUR #2	BLOCK BBB&C TRACT 1
Haskell	5834	643.4 ACRES	A-551 BBB&C RR. CO. SUR #4	TRACT 1
Haskell	5835	647.4 ACRES	A-553 BBB&C RR. CO. SUR #14	TRACT 1
Haskell	5836	583.3 ACRES	A-577 BBB&C RR. CO. SUR #12	TRACT 1
Haskell	5837	248.3 ACRES	A-584 GAINES W. SUR #7	TRACT 1
Haskell	5838	75.0 ACRES	A-597 BBB&C RR. CO. SUR #22	TRACT 1
Haskell	5839	175.3 ACRES	A-598 BBB&C RR. CO. SUR #24	TRACT 1
Haskell	5840	508.2 ACRES	A-625 BBB&C RR. CO. SUR #18	TRACT 1
Haskell	5841	498.7 ACRES	A-634 HUGHES H.J. SUR #16	BLOCK (BBB&C RR CO) TRACT 1
Haskell	5842	641.0 ACRES	A-661 MOORE F.C. SUR #2	BLOCK (GC&SF RR) TRACT 1
Haskell	5843	659.1 ACRES	A-662 MOORE F.C. SUR #4	BLOCK (GC&SF RR) TRACT 1
Haskell	5844	8.42 ACRES	A-840 GC&SF RR. CO. SUR #5	BLOCK 1 TRACT 1
Haskell	5845	165.4 ACRES	A-863 MORRIS A.F. SUR #20	BLOCK (BBB&C RR CO.) TRACT 1
Haskell	5846	381.5 ACRES	A-1071 CHRISMAN O.W. SUR#6	BLOCK (BBB&C) TRACT 1
Haskell	5846	381.5 ACRES	A-1071 CHRISMAN O.W. SUR#6	BLOCK (BBB&C) TRACT 1
Haskell	31630	609.8 ACRES	A-54 BBB&C RR. CO. SUR #7	TRACT 1A
Haskell	31631	283.8 ACRES	A-1071 CHRISMAN O.W. SUR#6	BLOCK BBB&C TRACT 1A
Haskell	31632	0.3 ACRES	A-64 BBB&C RR. CO. SUR #1	TRACT 1A
Haskell	31633	8.2 ACRES	A-514 NABORS J.W. SUR #2	BLOCK BBB&C TRACT 1A
Haskell	31634	143.8 ACRES	A-634 HUGHES H.J. SUR #16	BLOCK BBB&C RR CO TRACT 1A
Haskell	31635	567.7 ACRES	A-62 BBB&C RR. CO. SUR #15	TRACT 1A
Haskell	31635	567.7 ACRES	A-62 BBB&C RR. CO. SUR #15	TRACT 1A
Haskell	31636	94.2 ACRES	A-597 BBB&C RR. CO. SUR #22	TRACT 1A